

SMTS RL119 1960 BRM P48

The BRM had developed the rear engine design during 1959, using the front end and 4 cylinder engine from the existing BRM 25 as a basis for the new tubular chassis, which retained the controversial 'bacon slicer' single rear brake. Jo Bonnier, Graham Hill and Dan Gurney drove the BRM team cars during 1960. The P48 took time to develop into reliable performers being unable to match the pace of their rivals Cooper and Lotus. Despite leading three Grand Prix the season was littered with retirements, only three top five results were recorded. Encouraging highlights included, Jo Bonnier leading in Argentina and the opening 16 laps of the Monaco GP, holding a comfortable second until suspension problems on lap 78. Graham Hill had his day at the British GP around Silverstone, after stalling on the grid he drove through the field to catch and pass the leader Jack Brabham and gained a slender lead for 16 laps before fading brakes forced an error with six laps to go, spinning into the bank and damaging the rear suspension. Second place in the non championship Silver City Trophy at Brands Hatch and 2 Heat wins and a Victory in the Tasman Series, when the cars had 4 brakes was little consolation.

- 1) CHASSIS dark metallic green
- 2) Front LOWER WISHBONES dark grey
- 3) COCKPIT interior silver
- 4) Rear LOWER WISHBONES dark grey
- 5) DRIVE SHAFTS burnish, hubs grey
- 6) Rear AXLE RETAINER black
- 7) GEAR LEVER silver
- 8) FUEL VALVE burnish, matt black pipes
- 9) SEAT semi matt red
- 10) DASH PANEL matt black, frame dark grey
- 11) Front HUBS x 2 grey, discs silver
- 12) Front UPPER WISHBONES dark grey
- 13) TRACK RODS x 2 burnish
- 14) Front COIL SPRINGS silver, matt black coils
- 15) BODYWORK dark metallic green
- 16) NOSE PANEL dark metallic green
- 17) Lower body SCOOP
- 18) Headrest PANEL burnish
- 19) GEARBOX END gunmetal
- 20) Rear BRAKE DISC etch silver
- 21) Rear brake CALIPER burnish
- 22) EXHAUST PIPE gunmetal
- 23) Rear ANTI ROLL BARS 1 pair burnish
- 24) Rear COIL SPRINGS x 2 silver, coils black
- 25) Water FILLER CAP burnish
- 26) Oil FILLER CAP burnish
- 27) Steering wheel SPOKES
- 28) Steering wheel RIM semi matt brown
- 29) Front WHEELS x 2 silver
- 30) Front TYRES
- 31) Rear WHEELS x 2 silver
- 32) Rear TYRES
- 33) Wheel Spinners x 4 etch
- 34) SCREEN vac form
- 35) MIRRORS x 2 dark metallic green

HEATH WARNING: Please ensure that when working with whitemetal, dust particles are not inhaled and that hands are thoroughly washed prior to eating.

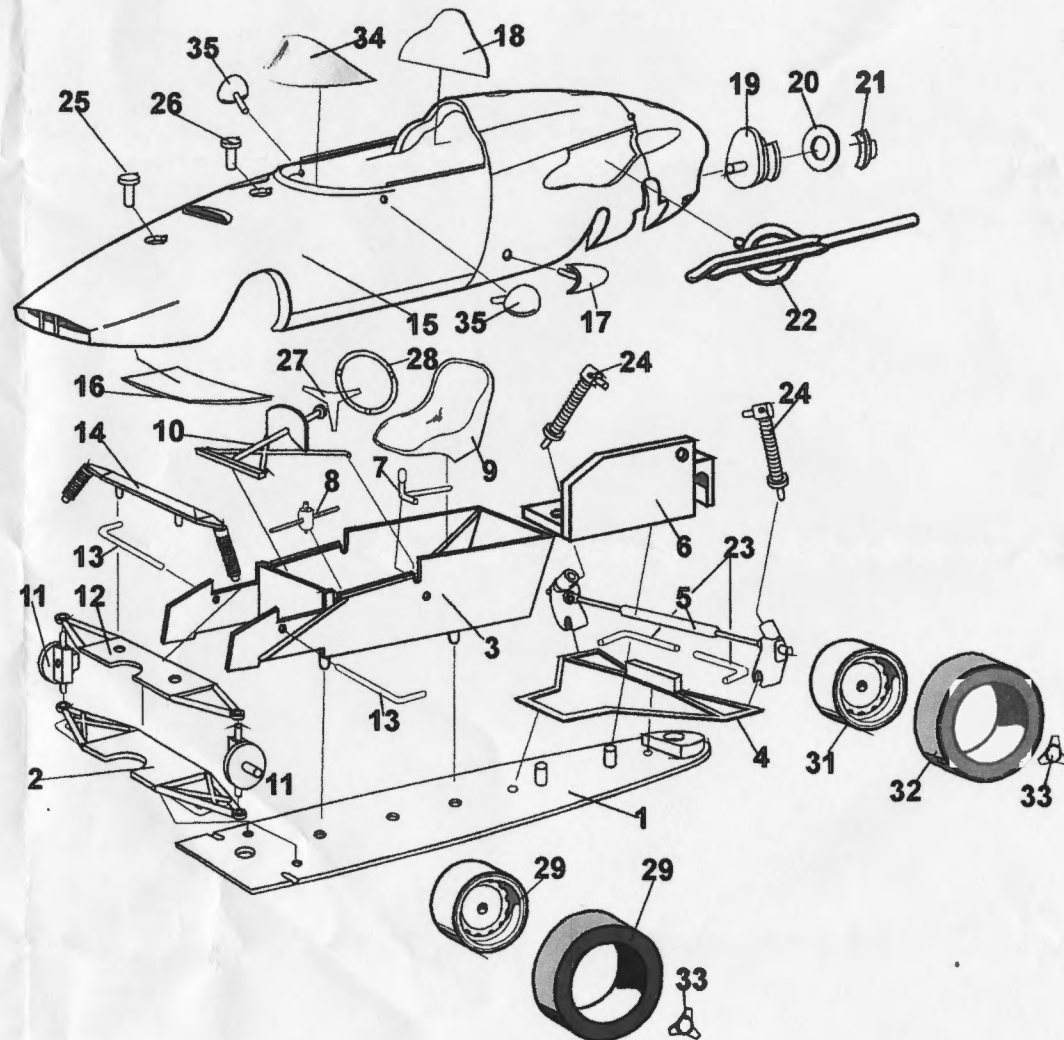

Check all parts against the exploded drawings, clean off any casting flash with a modelling knife and needle files, and drill out all location holes. Paint parts prior to assembly using automotive paints in aerosol form, commencing with primer followed by 3 to 4 light coats of colour. Assembly should follow the numerical sequence of the parts list, we suggest the use of epoxy or contact adhesive. Decals should be soaked in warm water, slid into place and pressed down firmly with a soft absorbent cloth.