

42.Honda RA 301-F1 1968

Made with the assistance of the Make-up Co. Tokyo, Japan

Building your 1/43rd Scale Racing Car.

The 31litre V12 RA 301 was driven by John Surtees. At it's first race, the Spanish GP, it was in 3rd place but retired when a gear selector failed.

At the French GP Surtees finished 2nd even after stopping for a new pair of goggles. The new high wing fitted for the British GP collapsed during the race but Surtees still finished 5th!

A 3rd place in the US GP was the final result of a season spoiled by mechanical problems.

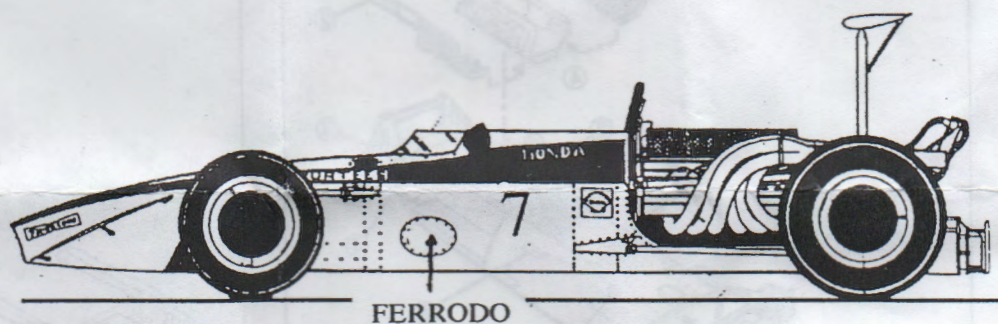

FRENCH GP CAR No 16 NO WING. BRITISH GP CAR No 7 WITH WING.

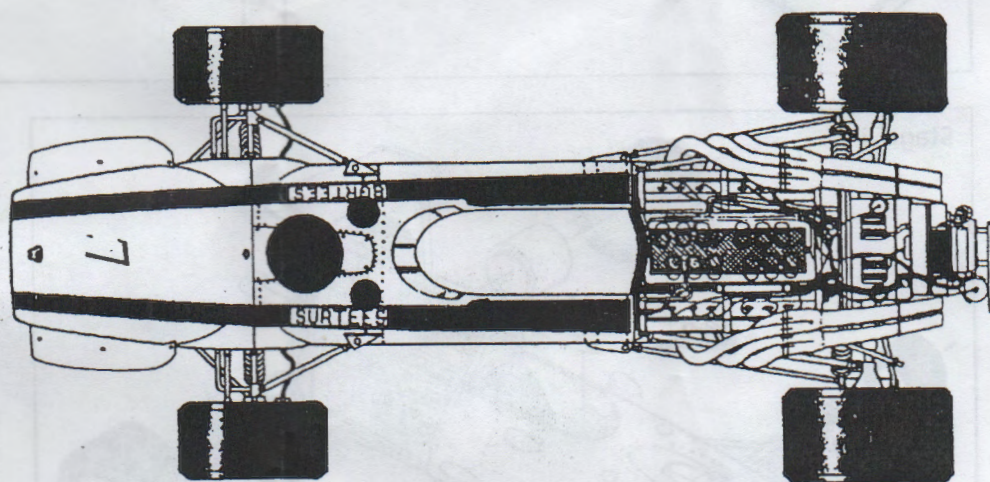

Scale Racing Cars

7 Wolfe Close, Cottingham, East Yorkshire HU16 5ET

Scale Racing Cars® ASSEMBLY INSTRUCTIONS

Stage 1

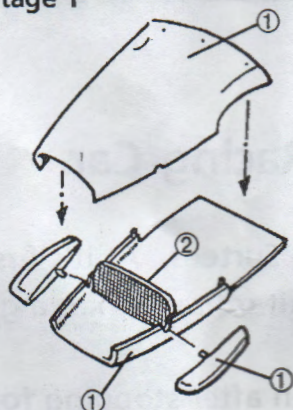

Stage 2

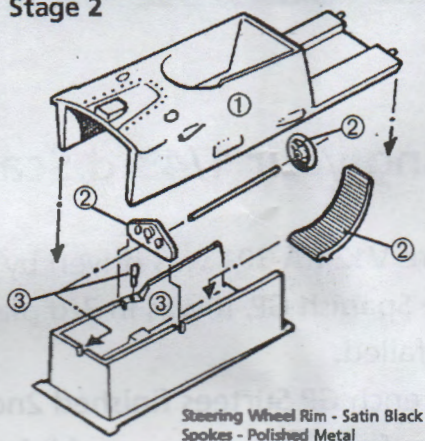

Stage 3

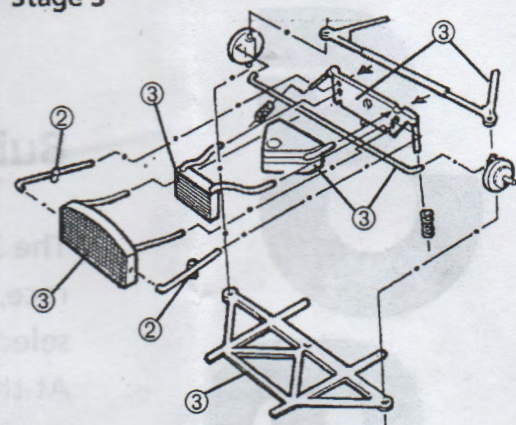

Stage 4

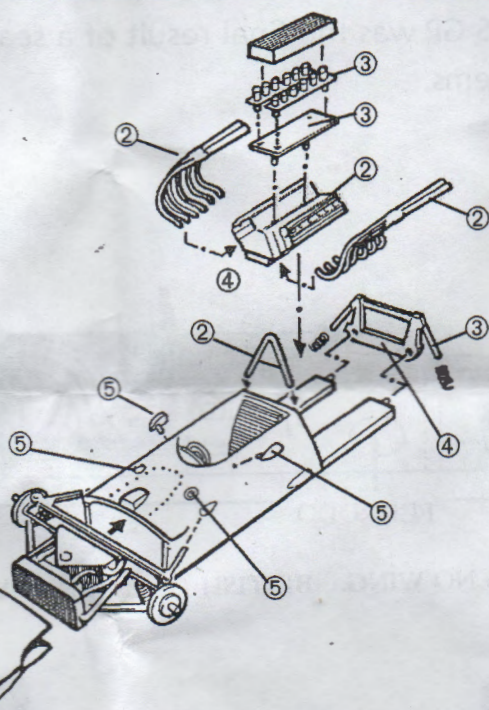

Stage 5

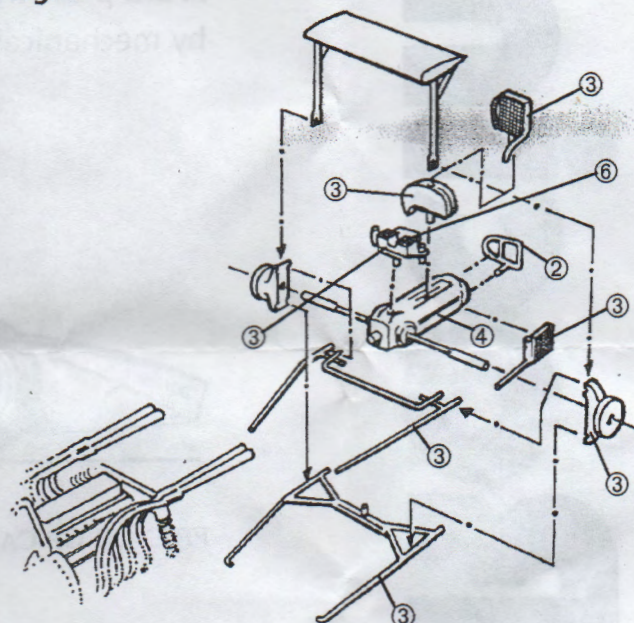

Stage 6

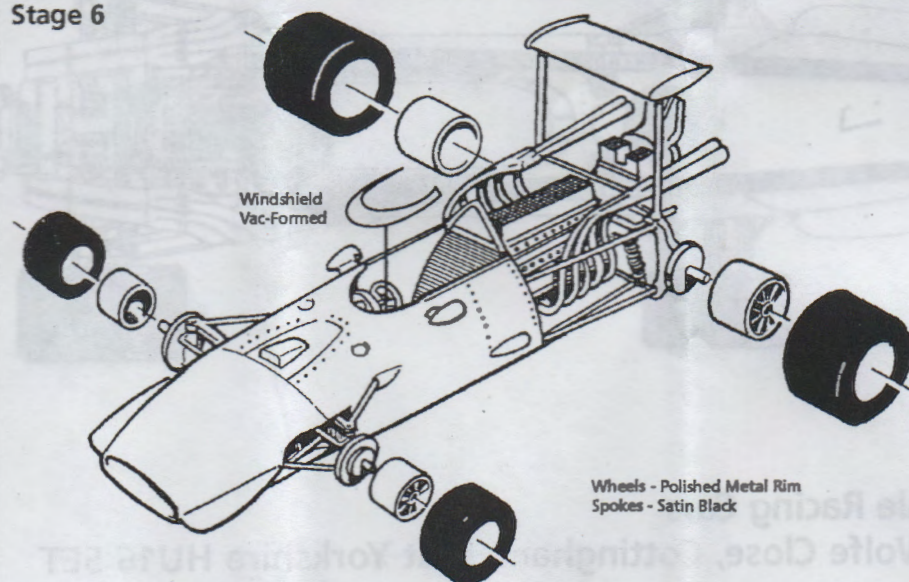

Paint Colours

- ① Gloss White ② Satin Black
③ Polished Metal ④ Gun Metal
⑤ Gloss Red ⑥ Gold

Also available:

- Kit No.15 Honda RA 273
Kit No.20 Honda RA300
Kit No.26 Honda RA 272 Mod
Kit No.39 Honda RA 302

The contents of the kit illustrated may vary as we continue to improve our products