

## RL70 1959 Aston Martin DBR4

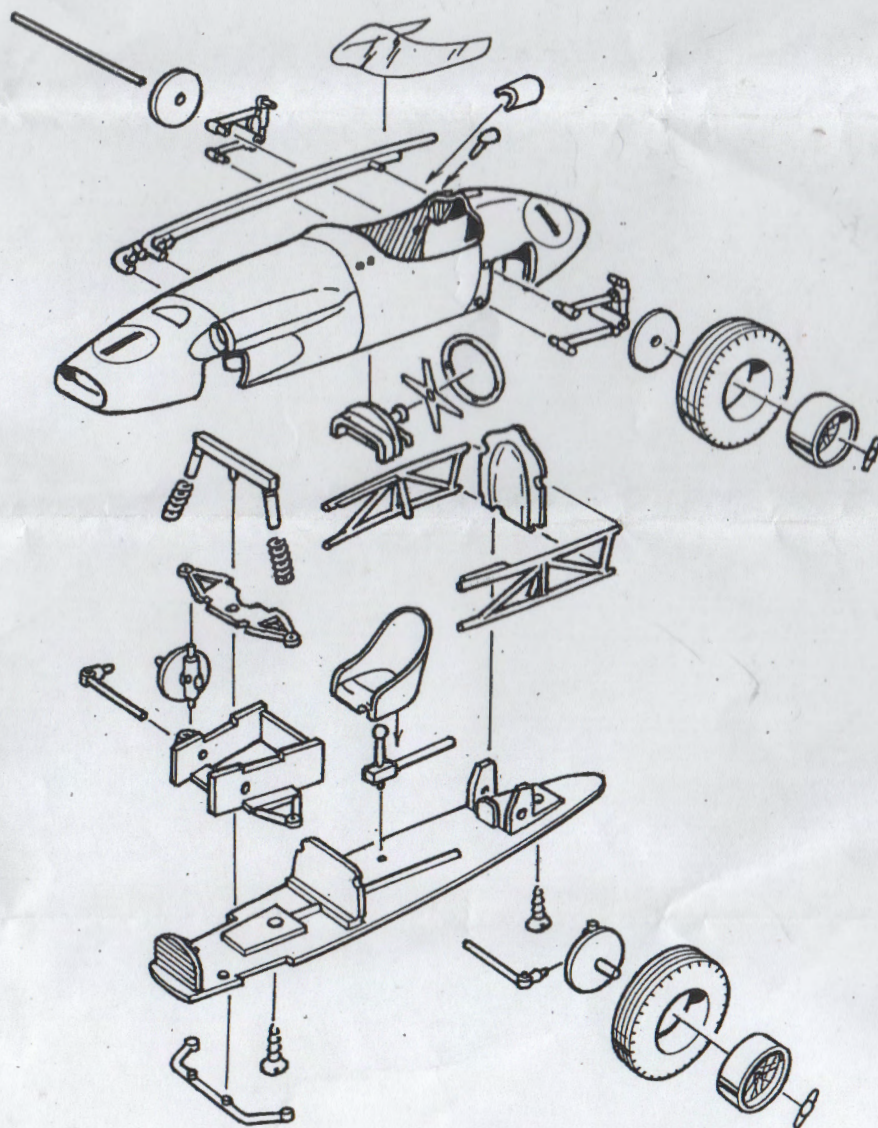

In 1955 the owner of Aston Martin, David Brown, asked his competitions department to build a Formula 1 car. The small design team, led by Ted Cutting, started work on the car alongside their new sports car, the DBR1. Naturally both cars had much in common. However work on the F1 car was put on the back-burner as the team concentrated on its major goal, winning the Le Mans 24 hour race, which it succeeded in doing in 1959. By then F1 was going rear-engined, the DBR4 was too little too late, its best result being 2nd, on its debut, in the 1959 Silverstone International Trophy driven by Roy Salvadori. It was all downhill for the DBR4s and up-graded DBR5s from then on, Aston Martin withdrawing from F1 in 1960.

- |  |   |
|--|---|
| 1 Chassis <i>silver</i>                  | 17 Rear suspension left <i>steel</i>    |
| 2 Front lower suspension <i>steel</i>    | 18 Rear suspension right <i>steel</i>   |
| 3 Front upper suspension <i>steel</i>    | 19 Rear discs <i>silver</i>             |
| 4 Front shock absorbers <i>black</i>     | 20 Rear axle rod                        |
| 5 Front springs x2                       | 21 Rear wheels x2                       |
| 6 Front hubs <i>silver</i>               | 22 Rear tyres x2                        |
| 7 Steering arms <i>silver</i>            | 23 Front wheels x2                      |
| 8 Front anti-roll bar <i>silver</i>      | 24 Front tyres x2                       |
| 9 Chassis frame left <i>light grey</i>   | 25 Knock-off caps x4 <i>etch</i>        |
| 10 Chassis frame right <i>light grey</i> | 26 Exhaust <i>gunmetal</i>              |
| 11 Gear lever/shaft <i>silver</i>        | 27 Steering wheel spokes <i>etch</i>    |
| 12 Rear bulkhead <i>silver</i>           | 28 Steering wheel rim <i>brown</i>      |
| 13 Seat <i>khaki</i>                     | 29 Screen                               |
| 14 Body Aston Martin racing <i>green</i> | 30 Mirrors x2 <i>body colour</i>        |
| 15 Dashboard <i>black</i>                | 31 Mirror shrouds x2 <i>body colour</i> |
| 16 Screws x2                             |   |

Check parts against the exploded drawing and parts list. Clean off any casting flash and mould split lines with a modelling knife, needle files or wet and dry abrasive paper. Drill out all location holes and paint parts prior to assembly using automotive paints in aerosol form commencing with primer followed by 3 or 4 light coats of colour. Assembly should follow the numerical sequence of the drawing and parts list, we suggest the use of 2-part epoxy or contact adhesive and advise against the use of cyanoacrylates unless you are an experienced model builder. Decals should be soaked in warm water, slid into place and pressed down firmly with a soft absorbent cloth.

**HEALTH WARNING:** Ensure when working with whitmetal that dust particles are not inhaled and that hands are thoroughly washed prior to eating. SMTS Ltd has a policy of constant development, parts in this kit may differ slightly from those illustrated as we strive to make improvements to our products. No part of this kit may be reproduced without permission from SMTS Ltd