

40. Lotus-BRM 43 Watkins Glen 1966

Team Lotus struggled through the 1966 season using 2 litre Climax and BRM engines before introducing the 3 litre BRM H16 powered Type 43 at the Belgian Grand Prix. The engine and its gearchange were very unreliable but at the US Grand Prix, at Watkins Glen, Jim Clark won after most of the other competitors had retired. Team Lotus were using BRM's spare engine as their own had blown in practice.

Building your 1/43rd Scale Racing Car.

Please check that all parts are present before removing any 'flash' left by the casting process with suitably shaped needle files and a modellers knife. It may be necessary to clear some locating holes with a small drill. Referring to the drawings over leaf, test fit the parts together, trimming if required to ensure a perfect fit.

Any surface imperfections should be filled and castings carefully rubbed with wet-or-dry paper (No.600) used wet, before spraying the gloss finish. Paint the small parts with model enamel using our guide as a reference. Use a quick setting epoxy adhesive to assemble the model taking care not to use too much.

The transfers are waterslide type. Cut up the backing sheet before soaking in warm water to release them. Use a fine paint brush to pick up the small ones.

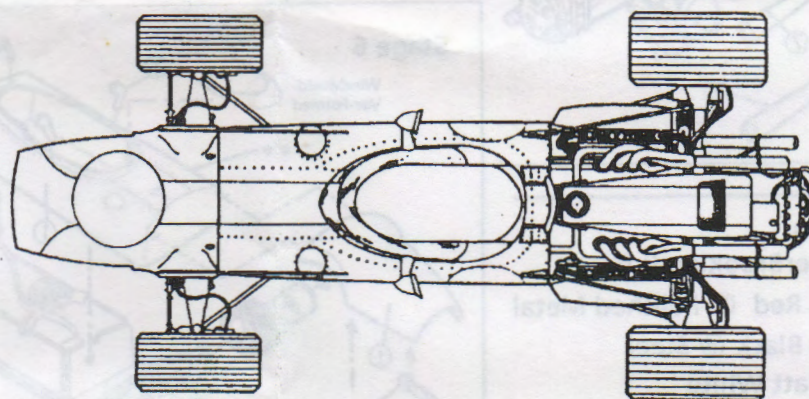
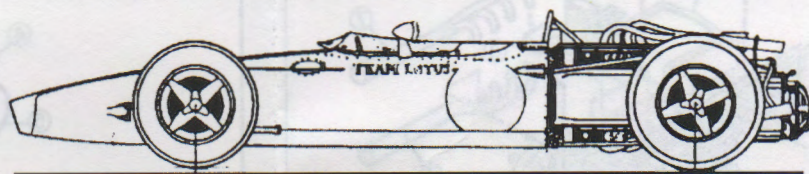

Scale Racing Cars

7 Wolfe Close, Cottingham, East Yorkshire HU16 5ET

Scale Racing Cars® ASSEMBLY INSTRUCTIONS

Stage 1

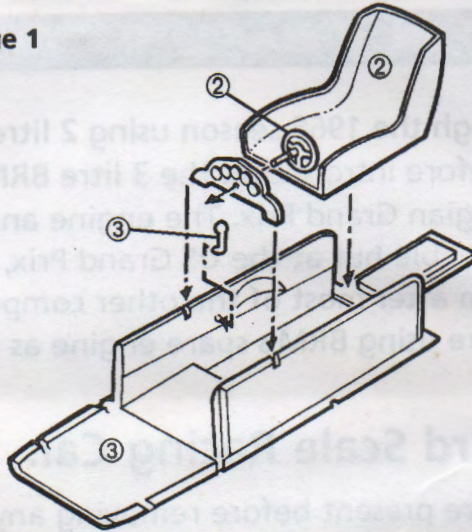

Stage 2

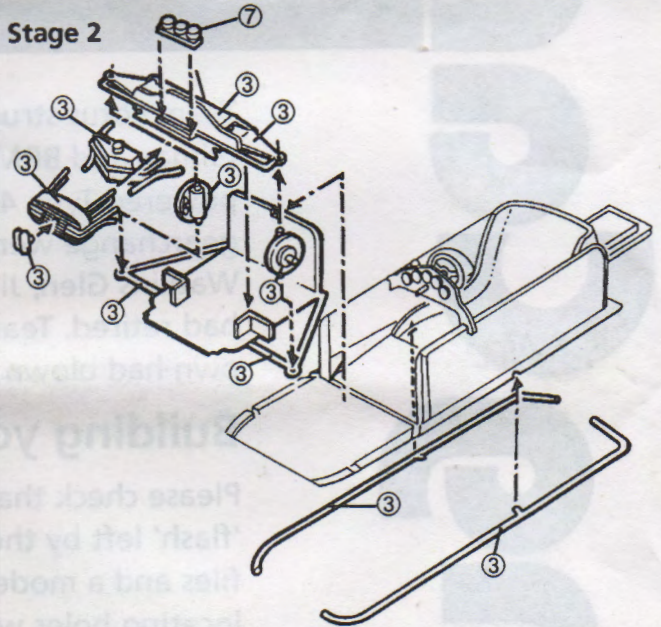

Stage 3

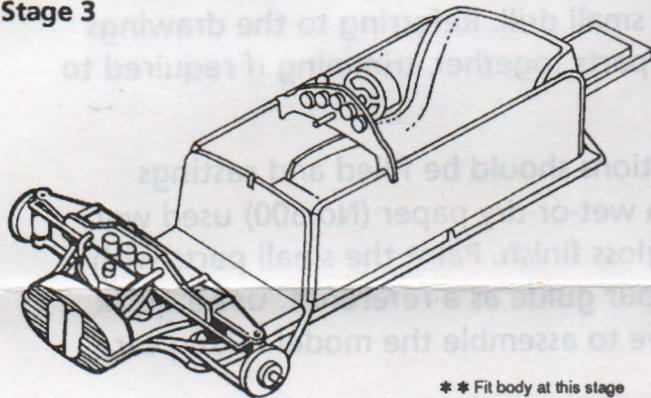

*** Fit body at this stage

Stage 4

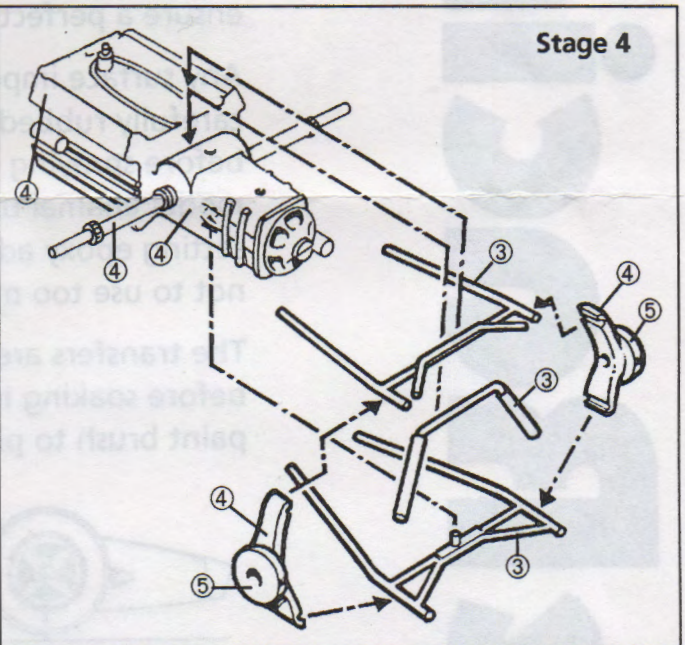

Stage 5

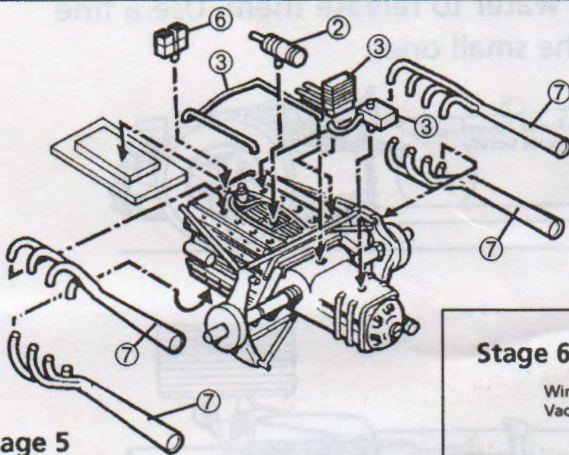

Stage 6

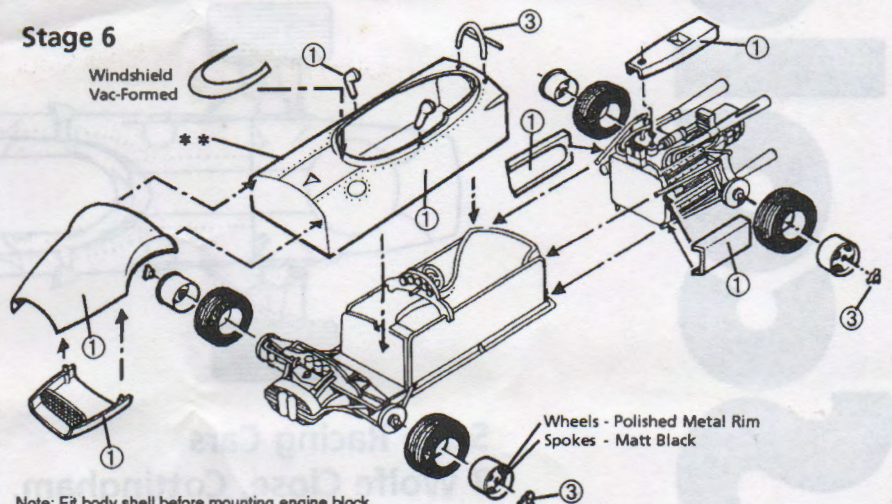

Windshield
Vac-Formed

Wheels - Polished Metal Rim
Spokes - Matt Black

Note: Fit body shell before mounting engine block

Paint Colours

- ① Austin Rover Brooklands Green
- ② Semi-Gloss Red ③ Polished Metal
- ④ Semi-Gloss Black ⑤ Steel
- ⑥ Gold ⑦ Matt White

The contents of the kit illustrated may vary as we continue to improve our products