

Scale Racing Cars

7 Wolfe Close Cottingham HU16 5ET

England

HONDA RA 272 MODIFIED

THE HONDA RA 272 MODIFIED WAS HONDA'S FIRST FORMULA 1 VICTORY (IN THE 1965 MEXICAN G.P.) IT WAS ALSO GOODYEAR'S FIRST FORMULA 1 WIN. UNFORTUNATELY DUE TO RULE CHANGES IT WAS ALSO THE LAST VICTORY IN THE OLD 1.5 -LITRE CLASS JUST AS HONDA HAD GOT ALL THEIR COMPLEX ENGINEERING TO WORK.

REF:- CLASSIC RACING CARS C. POSTHUMUS AND GOODYEAR 250 G. P. WINS 1965-1991

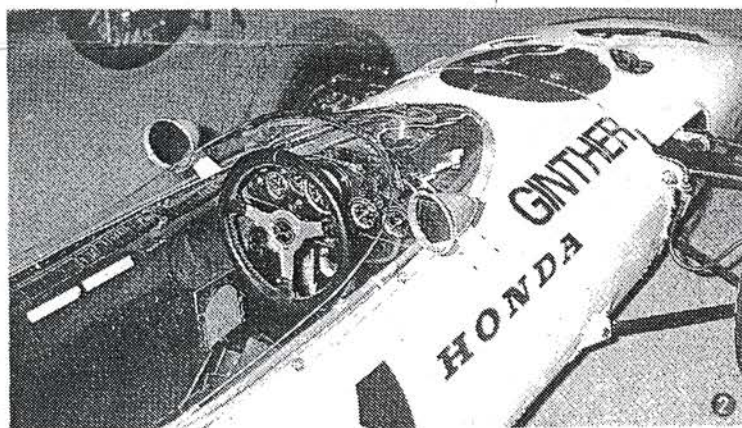

Building your 1/43rd Scale Racing Car

Please check that all parts are present before removing any 'flash' left by the casting process with suitable shaped needle files and a modellers knife. It may be necessary to clear some locating holes with a small drill.

Referring to the photographs showing various stages of assembly, test fit the components together, trimming if required to ensure a perfect fit. Any surface imperfections should be filled with cellulose putty and the castings carefully rubbed with wet-or-dry paper or steel wool before washing all parts in warm soapy water to remove any grease.

Using an auto spray apply a thin coat of primer carefully following the makers instructions. When dry gently smooth the surface with very fine (No. 600) wet-or-dry paper, used, wet, before spraying the gloss finish. The small parts should be painted with model enamel using our guide as a reference.

Assemble the model using a quick setting epoxy adhesive or instant glue, removing paint to achieve a better bond, and taking care not to use too much. The transfers are waterslide type and after cutting up the backing sheet require soaking in warm water to release them. Use a fine paint brush to pick up the small ones.

OTHER KITS AVAILABLE

- | | |
|---------------------------------------|----------------------------|
| 01 Embassy Racing Lola T370 | 15 Honda 273RA |
| 02 Yardley BRM P160 | 16 Ferrari 156 65 V6 |
| 03 J P S Lotus 72D | 17 Matra Ford MS80 |
| 04 Unipart Ensign N188 | 18 Cooper Maserati Type 81 |
| 05 Villiger Shadow DN9 | 19 Porsche 804 |
| 06 Marlboro BRM P160 | 20 Honda RA300 |
| 07 Lotus 76 / J P S Mk1 | 21 Ferrari 312PB |
| 08 & 09 Limited Edition Ferrari 312PB | 22 Ferrari 312 V12 |
| 10 Ferrari 156 120 V6 | 23 BRM Type P83 H16 |
| 11 Gold Leaf Lotus 72 | 24 Lotus 79 J P S |
| 12 Essex Lotus 88 | 25 Maserati 250F |
| 13 J P S / Courage Lotus 88B | 26 Honda RA272 " Modified" |
| 14 Ferrari 312PB TF | 27 Lotus 79 |

Scale Racing Cars

7 Wolfe Close Cottingham HU16 5ET

England

HONDA RA 272 MODIFIED

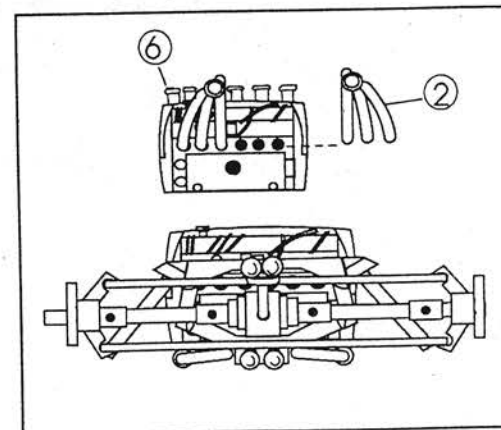
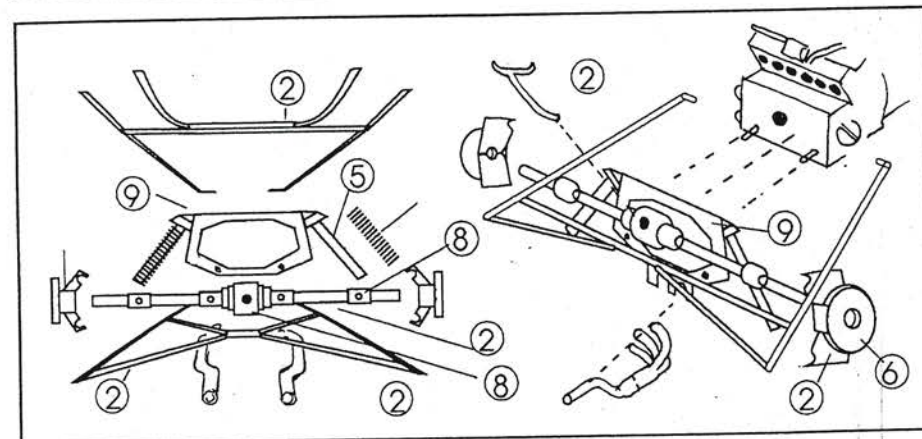
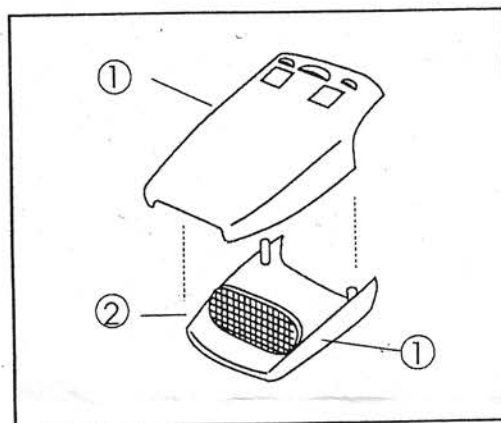
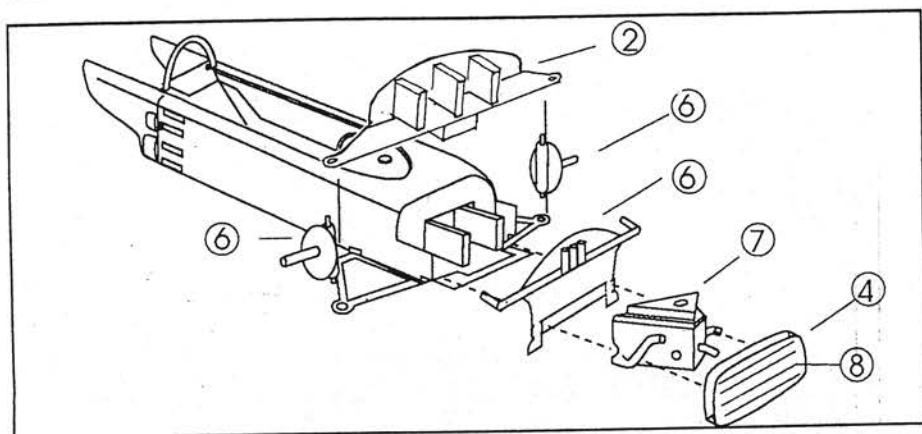
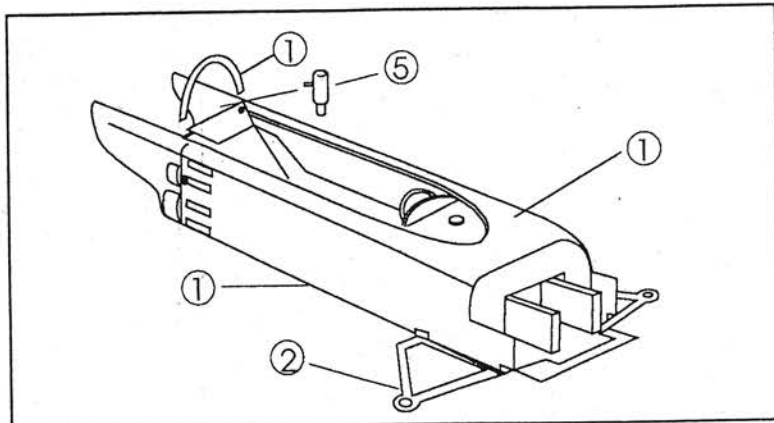
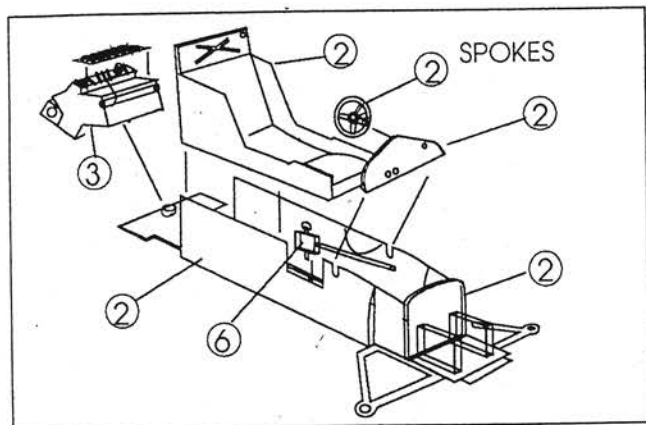

- ① OFF WHITE
- ② SEMI-MATT BLACK
- ③ MATT BLACK & ALLOY
- ④ GOLD
- ⑤ RED
- ⑥ POLISHED METAL
- ⑦ MATT GREY
- ⑧ ALLOY
- ⑨ GUN METAL

